



# Assembly and Owner's Manual

## TG475-2 Portable Gas Grill



L.P. Gas Cylinder  
Not Included



### **ASSEMBLER / INSTALLER:**

Leave these instructions with the consumer.

### **CONSUMER / USER:**

Read all of these instructions and keep them in a safe place for future reference.

#### **FOR YOUR SAFETY:**

If you smell gas:

1. Shut off gas to the appliance.
2. Extinguish any open flame.
3. Open lid.
4. If odor continues, immediately call your gas supplier or fire department.

#### **FOR YOUR SAFETY:**

1. Do not store or use gasoline or other flammable vapors and liquids in the vicinity of this or any other appliance.
2. An unconnected liquid propane cylinder should not be stored in the vicinity of this or any other appliance.

**FOR YOUR SAFETY: Never leave a grill unattended when in use.**

## Statement of Commitment

Congratulations and thank you for your purchase of your new Great Outdoors grill. We are pleased that you have recognized the value of the design, function, and quality of components used in this product. We believe it is among the finest on the market.

We are committed to producing quality products that your family will enjoy for years to come. If for any reason we have failed to meet or exceed your expectations, please allow us the opportunity to make it right by calling us toll-free:

**1-800-668-5323**

between the hours of 8:00 a.m. and 5:00 p.m.  
Eastern Standard time, Monday through Friday.

We want you to be completely satisfied with your purchase

**Formerly:** 

**Now:**   
CFM Corporation  
2695 Meadowvale Boulevard  
Mississauga, Ontario L5N 8A3 Canada  
(800) 668-5323

[www.cfmcorp.com](http://www.cfmcorp.com)

Service Note: If you are experiencing difficulties or are dissatisfied with your purchase, please contact CFM at the telephone number listed above prior to returning your grill to the store.

# Table of Contents

	Page Number
<b>Chapter 1 - INSTALLATION</b>	<b>4</b>
Necessary Information .....	4
Choosing a Safe Location .....	4
Portable L.P. Gas Grills .....	5-7
L.P. Gas Dealer Instructions .....	8
<b>Chapter 2 - ASSEMBLY INSTRUCTIONS</b>	<b>9</b>
Step 1 (Identifying Parts) .....	10
Replacement Parts .....	11
Step 2 (Cabinet Assembly) .....	12
Step 3 (Cabinet Assembly) .....	13
Step 4 (Grill Head) .....	14
Step 5 (Side Burner Valve) .....	15
Step 6 (Side Tables) .....	16
Step 7 (Side Tables) .....	17
Step 8 (Cooking Grids) .....	18
Step 9 (Cabinet Doors) .....	19
Step 10 (Drip Pan) .....	20
Installing an L.P. Gas Cylinder .....	21-22
<b>Chapter 3 - USE and CARE</b>	<b>23</b>
Leak Testing .....	24
Lighting Instructions .....	25-26
Side Burner Operation .....	27
Using Your Grill .....	28
Caring for Your Gas Grill .....	29
Cleaning and Maintenance .....	30
Warranty .....	31

# Pinnacle Series Gas Grill

## Installation Chapter 1

### Necessary Information to Safely Use a Gas Grill

The gas fuel used by this product is highly flammable and must be used in a responsible and cautious manner.

It is your responsibility to assemble, operate, and maintain your gas barbecue grill properly.



If these instructions are ignored, there is a possibility of a hazardous fire or explosion which could result in property damage, physical injury or death.

### Choosing a Safe Location for a Gas Barbecue Grill

1. The gas barbecue grill may only be used for cooking out-of-doors.
  - Do not operate this barbecue in garages, breeze ways, sheds or any enclosed area.
  - Operating this or any gas-fired appliance in an enclosed area can produce a build-up of carbon monoxide, which could result in injury or death.
2. Installation must conform with local codes or, in the absence of local codes, with either the National Fuel Gas Code, ANSI Z223.1, NFPA 54 (USA), or CAN/CGA-B 149.2 Propane Installation Code (Canada) and CAN/CGA-B 149.1 Natural Gas Installation Code.

To check local codes, contact your local gas dealer or gas company listed in the Yellow Pages for recommended installation procedures and regulations.
3. This appliance is not intended to be installed in or on a recreational vehicle and/or boat.
4. Keep the barbecue grill at least 24 inches (61 cm) away from any combustible construction.
  - Do not use a grill under a ceiling or cover where the heat or flame could cause damage.
  - Choose a level surface where the grill is not facing directly into the wind.
  - Avoid moving the grill during use.
5. The grill area must be clear and free from combustible materials, gasoline, and any other flammable liquids or vapors.
  - Do not use lighter fluid or charcoal briquettes in a gas grill. The flow of combustion and ventilation air is not to be obstructed. The ventilation openings of the cylinder enclosure must be kept free and clear from other debris. Do not store grill covers or other items in the cylinder area.



6. Do Not store a spare L.P. gas cylinder under or near this appliance.

Do not store an L.P. cylinder in a building, garage or any other enclosed area. Instead, store the cylinder outdoors in a well ventilated area, away from people and out of the reach of children.

**7. NOT FOR USE BY CHILDREN**

- Place your barbecue grill in a location away from children and pets.
- Do not leave grill unattended when in use.

**8. The outside of the barbecue grill will become hot during use.**

- To avoid burns, do not touch any hot grill surface. If necessary, use a protective glove when operating control knobs, tank shut-off valve or lid handle.
- Do not place combustible material, such as cloth or plastic, on grill surface during use.
- Do not lean on side tables or place more than 15 pounds of weight on a side table.

**9. The warming drawer is only to be used for keeping food warm.**

- Do not place any flammable material in the warming drawer.

10. Make sure that the drip pan is in place under the grill bottom.

- Hot drippings from cooking food could damage the fuel supply system.

**IMPORTANT:** NEVER leave a grill unattended when in use.

## Portable L.P. Gas Barbecue Grills

**WARNING:** Do not use natural gas in an appliance designed for L.P. gas. Use only liquid propane (L.P.) gas in an appliance designed for L.P. gas.

### L.P. Gas

Liquid Propane (abbreviated L.P.) gas is stored under high pressure inside a cylinder and will vaporize when released. It is important that there are no leaky connections on the grill fuel supply system. Refer to the Leak Testing section of this manual.

### The L.P. Fuel Supply System

An L.P. gas grill requires a fuel delivery system made up of a L.P. gas cylinder, a fuel regulator with hose and a gas-control valve.

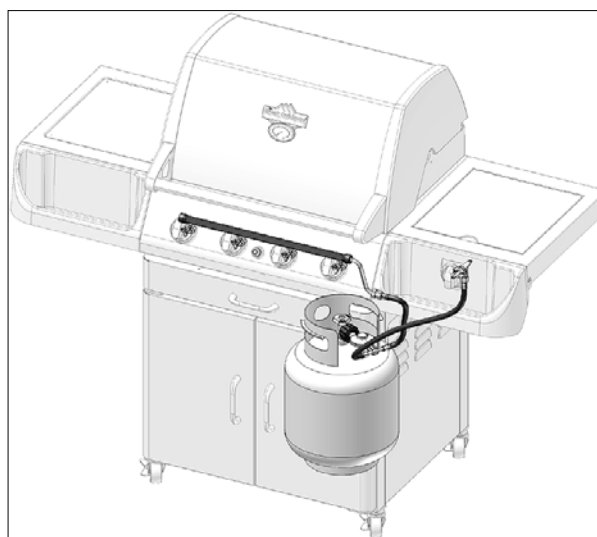

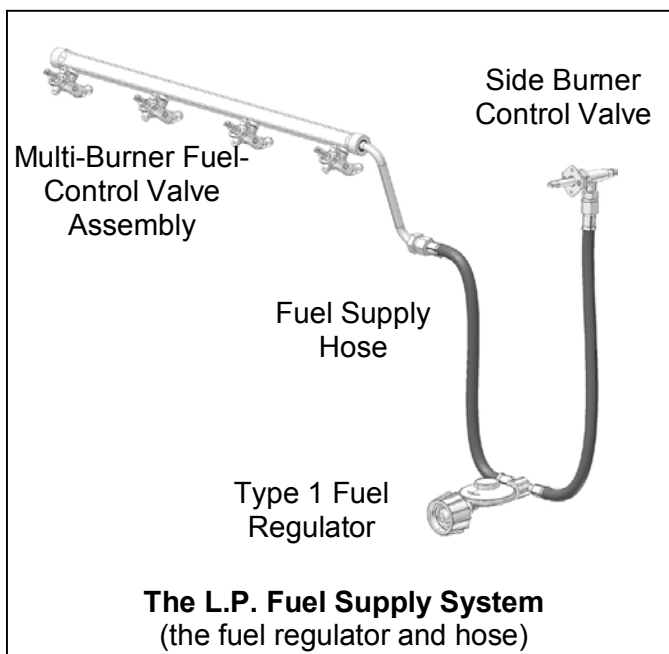

- The pressure regulator and hose assembly provided is factory set at an outlet pressure of 11 inches water column (.4 lb. per sq. Inch).

**WARNING:** Any attempt to adjust the regulator is dangerous and could create a situation causing personal injury or property damage. Consult your L.P. gas dealer if you think the regulator is not working properly.

#### L.P. GAS SUPPLY CYLINDER

L.P. Cylinders can be obtained at the store where you purchased your grill or from an authorized L.P. gas dealer.

#### FUEL REGULATOR AND HOSE

The fuel regulator supplied is equipped with a Type 1 coupling nut. Do not attempt to connect to any other L.P. cylinder not equipped with a mating Type 1 cylinder valve. This grill is not to be used with any other cylinder connection device.

The fuel regulator and hose assembly with the Type 1 fitting supplied must be used with the appliance. Do not use a hose and regulator assembly other than the one supplied with the grill or a manufacturer's replacement fuel pressure regulator assembly.

The Type 1 connection system has the following features:

- The system will not allow gas to flow until a positive connection has been made.
- The system has a thermal element that will shut off the flow of gas between 240°F and 300°F.
- The system has a flow-limiting device which, when activated, will limit the flow of gas to 10 cubic feet per hour.

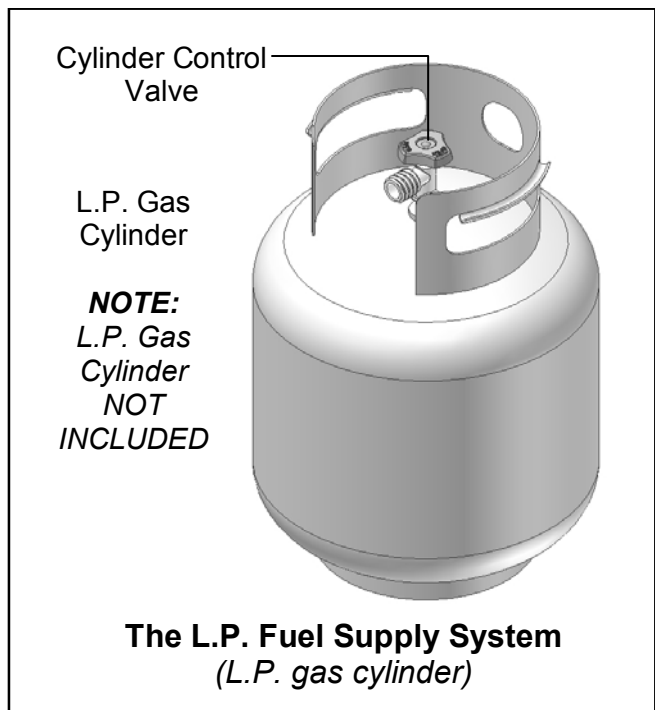

#### L.P. GAS CYLINDER SPECIFICATIONS

Any L.P. gas-supply cylinder used with this grill must be approximately 12 inches diameter and 18 inches high. The maximum fuel capacity must be 20 pounds of propane. Full-cylinder weight should be approximately 38 pounds (43.7 lbs. Nominal water capacity).

The L.P. gas cylinder must have a shut-off valve terminating in a Type 1 L.P. gas-cylinder-valve outlet. A Type 1 compatible cylinder with a Type 1 cylinder valve has a positive seating connection that does not permit gas flow until a positive seal has been obtained.

The cylinder must be arranged for vapor withdrawal. It must also include a collar to protect the cylinder valve. A safety-relief device having direct communication with the vapor space of cylinder must be provided. This will expel high-pressure gas if the cylinder is overfilled or overheated.

All L.P. gas cylinders used with this appliance shall be constructed and marked in accordance with the specifications for L.P. gas cylinders of the U.S. Department of Transportation (DOT) or the National Standard of Canada, CAN/CSA-B339, Cylinders, Spheres and Tubes for Transportation of Dangerous Goods; and Commission, as applicable; and shall be provided with a listed overfilling-prevention device. Read labels on the L.P. gas-supply cylinder.

**DANGER:** Do not insert any foreign objects into the valve outlet. You may damage the back check. A damaged back check can cause a leak, which could result in explosion, fire, severe personal injury or death.

**Allow only a qualified L.P. gas dealer to fill or repair an L.P. gas-supply cylinder.**

Inform the gas dealer if it is a new or used cylinder to be filled. Caution the gas dealer not to overfill the fuel cylinder.

After filling, have the gas dealer check for leaks and that the relief valve remains free to function.

Have the gas dealer weigh the cylinder after filling to ensure that the cylinder is not over-filled.

**DANGER:**

- a.) Do not store a spare L.P. gas cylinder under or near this appliance.
- b.) Never fill the gas cylinder beyond 80 percent full.
- c.) If the information in (a.) and (b.) is not followed exactly, a fire causing serious injury or death may occur.

## TRANSPORTING A FULL CYLINDER

**WARNING:** Handle a full cylinder with care. Gas is under high pressure.

You should transport only one cylinder at a time. Transport the cylinder in an upright and secure manner with the control valve turned off and the POL dust cap in place.

Do not transport a cylinder in the passenger compartment of a vehicle.

Do not leave cylinder in direct sunlight or in a high-heat area such as a closed car trunk. High-heat areas could cause the relief valve to vent gas.

Use a cylinder cap on the cylinder-valve outlet during transport and when the cylinder is not connected to the grill. Keep cylinder valve closed when not in use.



# Take These Instructions to the L.P. Gas Dealer

When using a cylinder exchange, be sure the exchanged cylinder is a Type 1 cylinder: a 510 POL cylinder will not fit a Type 1 regulator.

## FILLING AND PURGING TYPE 1 L.P. GAS CYLINDERS

**DANGER:** Purging and filling of L.P. gas cylinders must be performed by personnel who have been thoroughly trained in accepted L.P. gas industry procedures. Failure to follow this instruction may result in explosion, fire, severe personal injury or death.

**IMPORTANT:** Purge new cylinders before filling. This tank is easily filled with a standard CGA 510 POL filling connection.

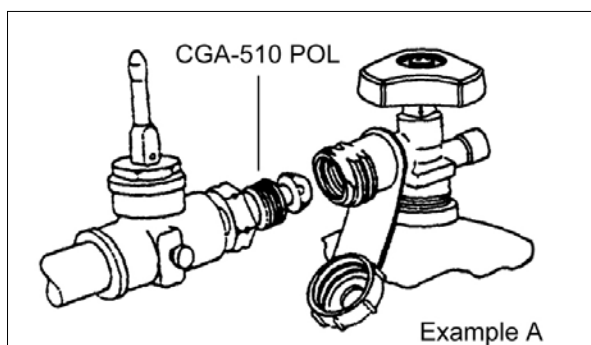

### Filling a Type 1 Cylinder Valve

*Example A: shows a CGA-510 POL fitting.*

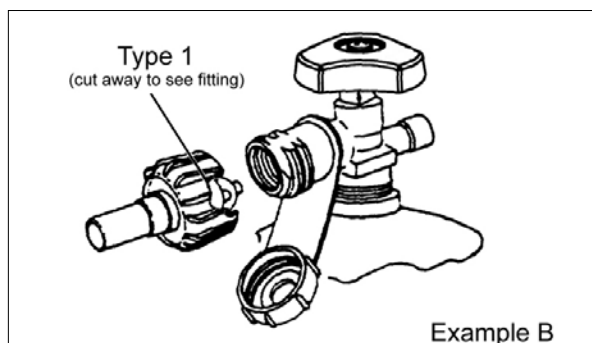

The L.P. gas cylinder has a Type 1 cylinder valve with a back-check module in its outlet

that will not permit gas to flow until an evacuation device is installed. To purge the L.P. gas cylinder, the back-check module must be opened with an evacuation device.

## PURGING AND EVACUATION DEVICES FOR L.P. GAS CYLINDER WITH TYPE 1 CYLINDER VALVES

- A. Hose-end valve with a bleed port: Purging can be accomplished using a hose-end valve containing a bleed port, which also allows for evacuation without the use of an adapter.
- B. Hose-end valve without a bleed port: When a hose-end valve does not have a bleed port, a separate device must be used for evacuation.
- C. Purging using a Type 1 connection: L.P. gas cylinder evacuation can be accomplished during each purging by using a Type 1 connection. The Type 1 valve outlet has 1-5/16" external ACME right-hand thread that will accept this connection.

**CAUTION:** After purging or filling an L.P. gas cylinder, do not insert a POL plug into the valve outlet. Insertion of this plug will prevent the back-check from closing. Use ONLY the provided cap and strap attached to the outlet. Close the cylinder valve knob before returning the cylinder to the customer.

For proper purging procedures in the USA, refer to: Safety Bulletin NPGA#133, "Purging L.P. Gas Cylinders," and Safety Bulletin NPGA#130, "Recommended Procedures for Filling Cylinders."

**DANGER:** Do not fill an L.P. gas cylinder beyond 80% full. If this information is not followed exactly, a fire causing serious injury or death may occur.



# Pinnacle Series Gas Grill

## Assembly Instructions Chapter 2



### Getting Started

1. Please follow the steps in the order that they are presented.
2. Assemble the grill where you plan to use it.
3. You may want to place an old towel or cloth at the assembly site to prevent nuts and bolts from becoming lost.
4. Have a friend help. An assistant can make the assembly easier by holding the parts in place while you fasten the nuts and bolts.
5. To be ready to barbecue immediately, have the L.P. gas cylinder filled by an authorized L.P. dealer or cylinder exchange center.

### Unpacking the Grill Parts

1. Remove and set aside all inner boxes and parts from the master carton.
2. Remove and set aside all wrapping paper and additional packaging from the parts.
3. Do not destroy carton or packing until your grill is completely assembled and operating to your satisfaction.

### Tools needed to assemble grill:

- Phillips-head screwdriver

### TOOLS NOT INCLUDED

**ESTIMATED TIME FOR ASSEMBLY -  
30 MINS**

# Assembly Step 1—Identifying the Grill Parts

*Locate these parts:*

Note: Refer to the parts listing on page 11

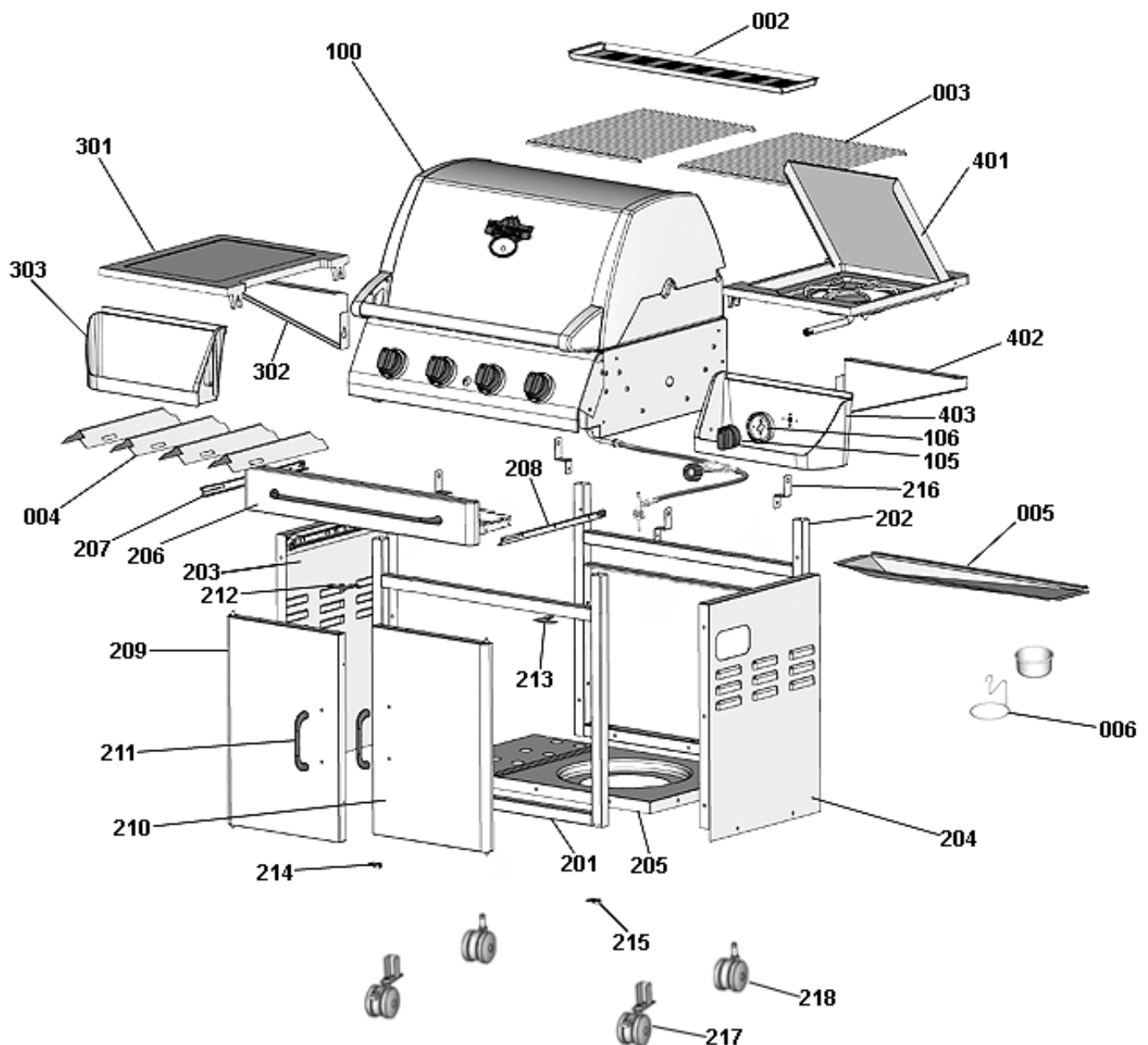

*Not Pictured:*  
**001 Master Hardware Pack**

# Model TG475-2 Replacement Parts

Replacement parts are available direct from our warehouse. Some components are not available preassembled and may be ordered separately. For convenience, the following parts list is provided along with a representation of the items listed. Charges for replacement parts and shipping may apply. For warranty replacements, proof of ownership and date of purchase is required. Please call to receive a return authorization number before returning any grill components. To order parts, call toll-free: in the USA 1-800-944-8982 and In Canada 1-800-668-5323

## Parts and Assemblies (See page 10)

Ref	Description	Part No.
001	Master Hardware Pack	50002674
002	Warming Rack	50002675
003	Cooking Grids	50002676
004	Heat Shield	50002586
005	Drip Tray	50002677
006	Drip Tray Bracket	50002568
100	<b>Grill Head Assembly</b>	50002678
101	Heat Indicator	50002549
102	Nameplate	50002588
103	Grill Tub	50002680
104	Stainless Steel Burner	50002681
105	Burner Knob	50002552
106	Knob Bezel	50002551
107	Electronic Ignitor	50002658
108	Valve Assembly	50002682 / 50002703
109	Hose / Regulator	50002683 / 50002679
110	Ignitor Plate	50002533
200	<b>Grill Cabinet</b>	50002684
201	Front Cabinet Frame	50002685
202	Rear Cabinet Frame	50002686
203	Left Cabinet Panel	50002687
204	Right Cabinet Panel	50002688
205	Bottom Cabinet Panel	50002689
206	Warming Drawer	50002690
207	Warming Drawer Runner LH	50002691
208	Warming Drawer Runner RH	50002692
209	Cabinet Door LH	50002693
210	Cabinet Door RH	50002694
211	Cabinet Door Handle	50002577
212	Upper Door Bracket LH	50002695
213	Upper Door Bracket RH	50002676
214	Lower Door Bracket LH	50002697
215	Lower Door Bracket RH	50002698
216	Burner Box Bracket	50002699
217	Locking Caster Front	50002700
218	Caster Rear	50002657
219	Caster Rear Insert	50002701
300	<b>Left Side Table</b>	50002583
301	LH Side Shelf	50002636
302	LH Side Shelf Bracket	50002635
303	LH Side Basket	50002637
400	<b>Right Side Burner Table</b>	50002702
401	RH Side Burner Shelf	50002644
402	RH Side Shelf Bracket	50002643
403	RH Side Basket	50002645
404	Burner and Ignitor	50002639
405	Cooking Grate	50002642
406	Side Burner Cover	50002648

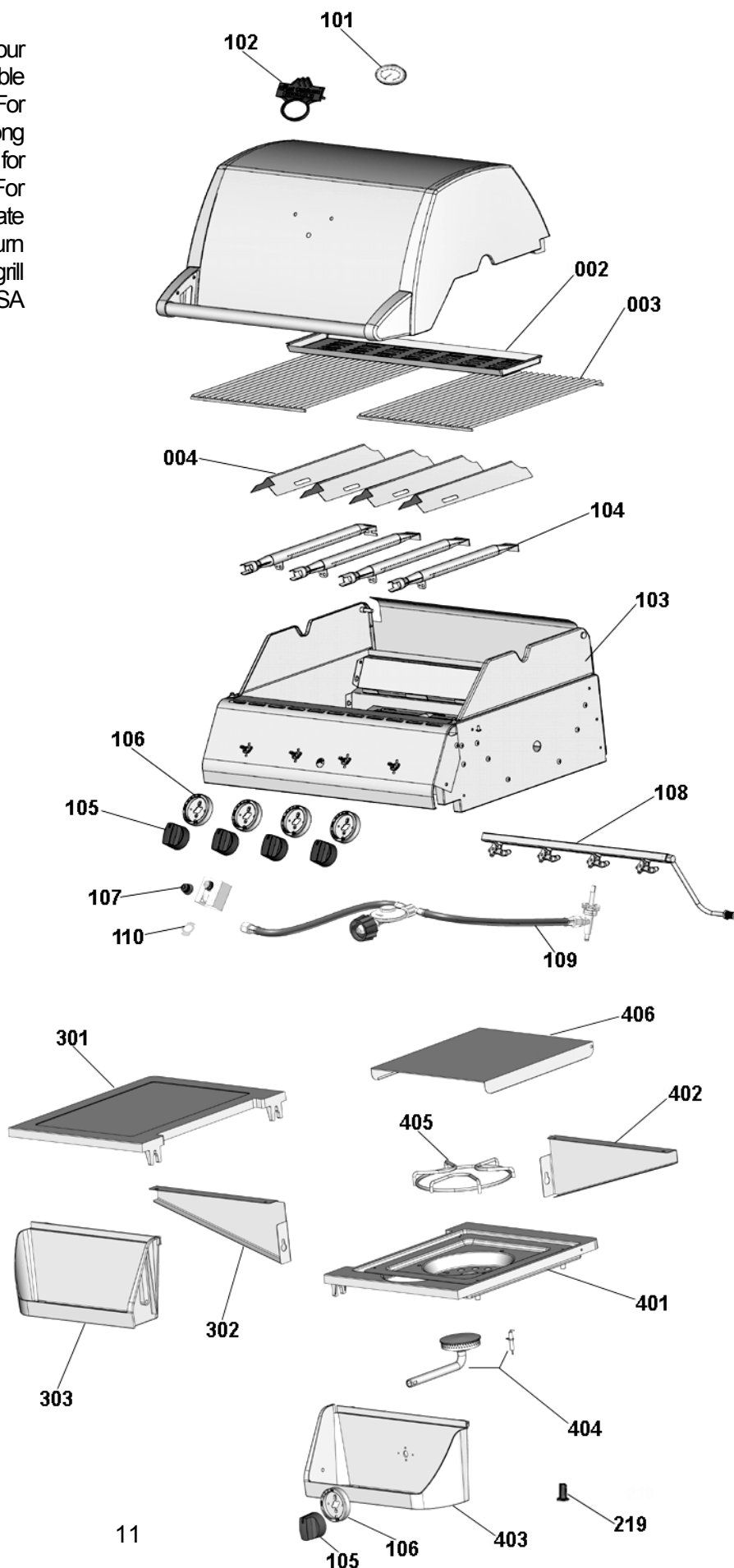

## Assembly Step 2—Cabinet Assembly

### USE HARDWARE 'STEP 2'

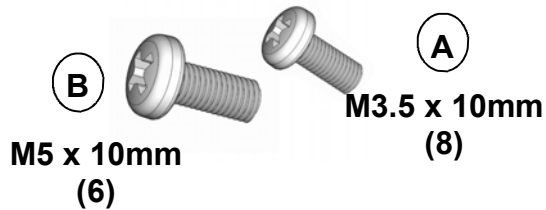

### LOCATE THESE PARTS

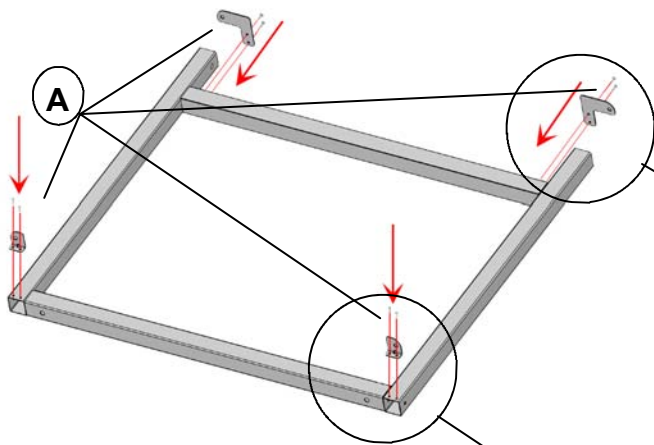
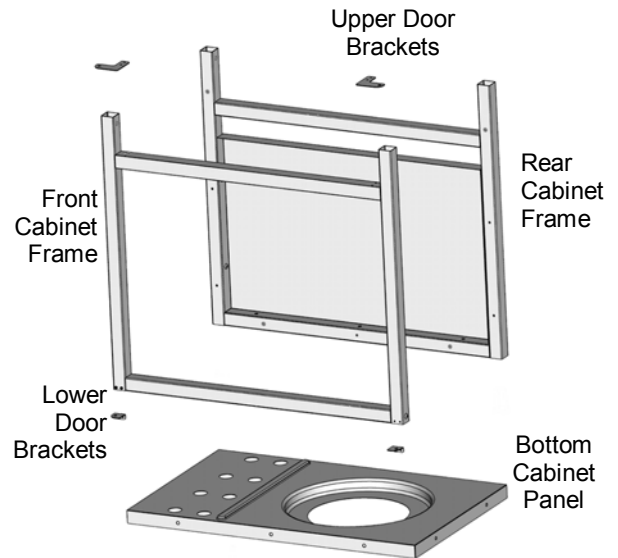

1. Fix the upper and lower door brackets to the front cabinet frame as shown using 3 M5 screws. Note the orientation of the upper and lower door brackets.

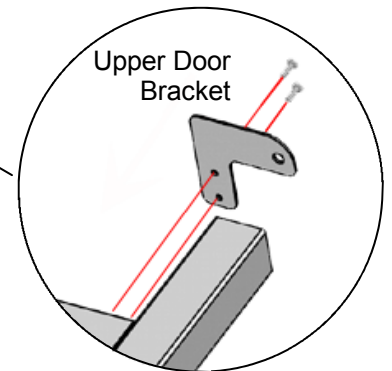
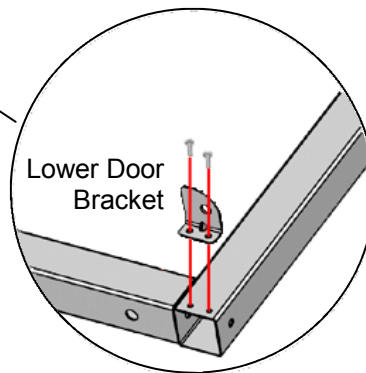

2. Position the bottom cabinet panel onto the rear cabinet frame as shown and locate using 3 M5 screws. Repeat for the front cabinet frame.

**IMPORTANT:** Note the orientation of the bottom cabinet panel relative to the frame.

3. Securely tighten all screws.

**NOTE: IT IS RECOMMENDED TO ASSEMBLE THE GRILL ON THE SHIPPING CARTON TO AVOID SCRATCHING THE PAINT.**

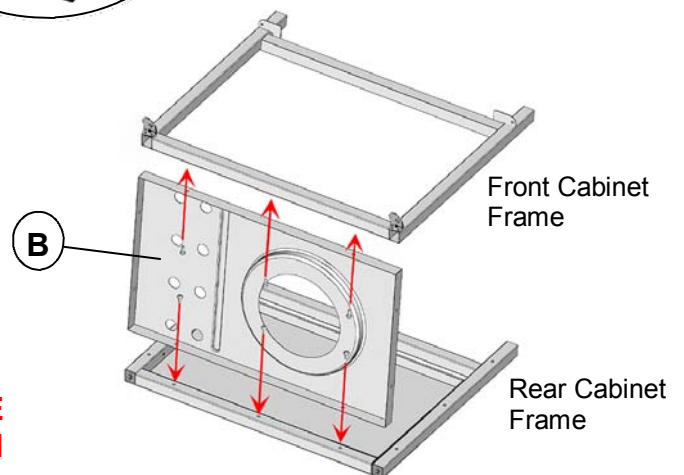

## Assembly Step 3—Cabinet Assembly

### USE HARDWARE 'STEP 3'

A



M5 x 10mm  
(16)

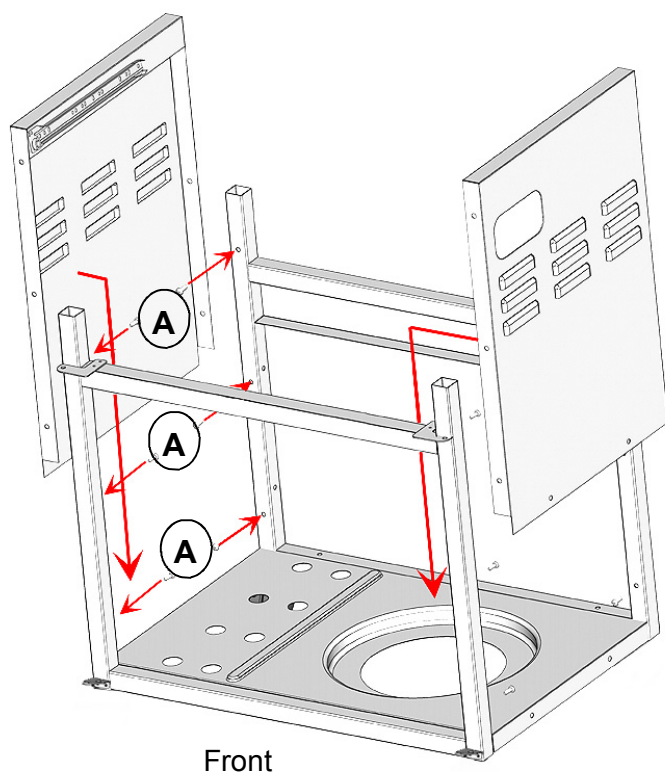

Front

3. From the underneath side of the cabinet assembly, insert M5 screws at the bottom of each side panel through the bottom cabinet panel.
4. When all screws are mounted, securely tighten all screws.

### LOCATE THESE PARTS

Left  
Cabinet  
Side Panel

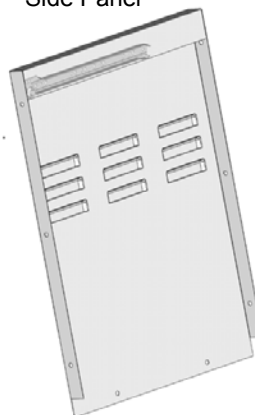

Right  
Cabinet  
Side Panel

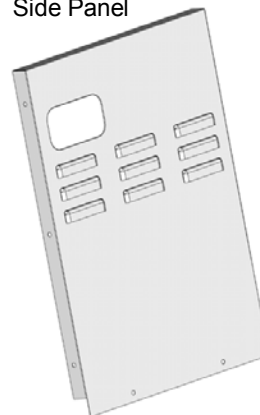

1. Position the cabinet side panels as shown. The panels must be inserted to the inside of the cabinet assembly.  
**IMPORTANT:** Note the orientation of the right cabinet side panel to the cabinet frame.
2. Align the mounting holes and insert M5 screws.

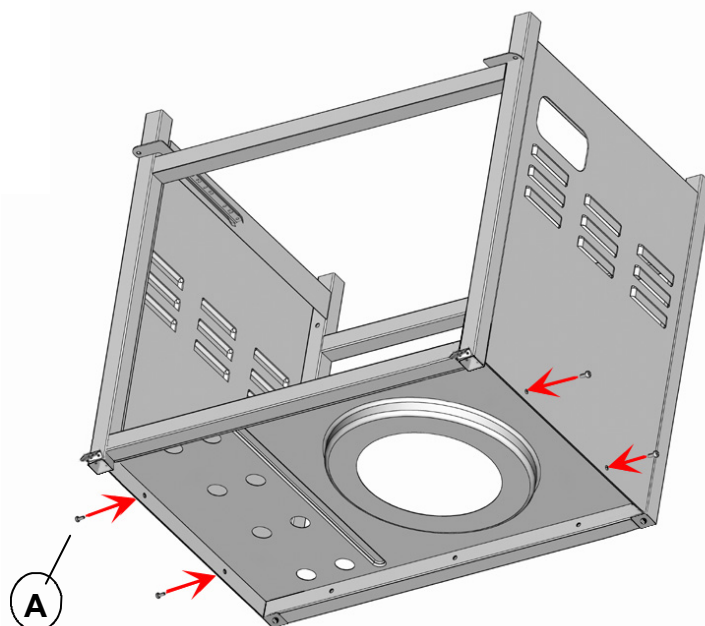

# Assembly Step 4—Install the Grill Head

## USE HARDWARE 'STEP 4'

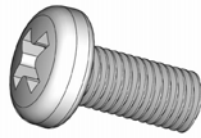

**M5 x 10mm  
(10)**

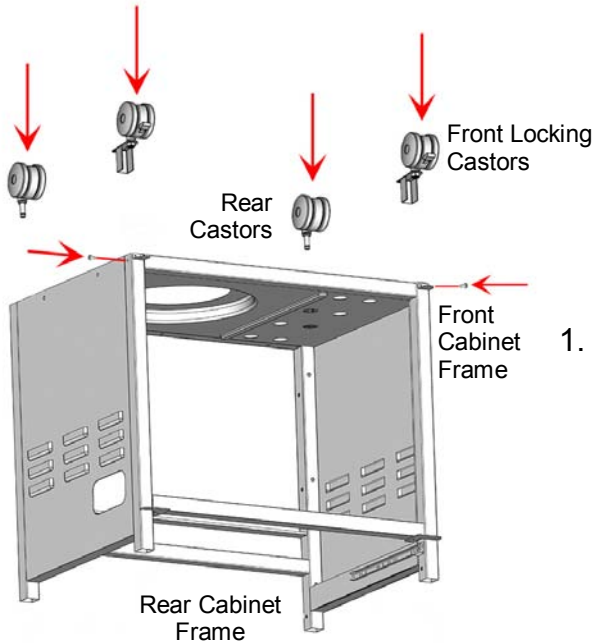

## LOCATE THESE PARTS

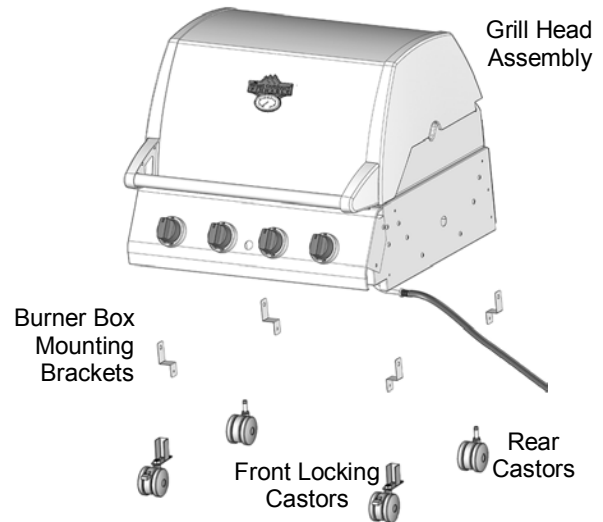

1. Position the cabinet frame upside down onto a firm surface and insert the castors. The front locking castors can be identified by the square stem. Insert them into the front cabinet frame and fix using a M5 screw as shown. Push the rear castors into the plastic inserts located at the bottom of the rear cabinet frame. Check that all castors are securely in position.

2. Locate the mounting brackets and fix to the top of each post on the cabinet assembly as shown using M5 screws. Note the orientation of the brackets to each post, slot up.

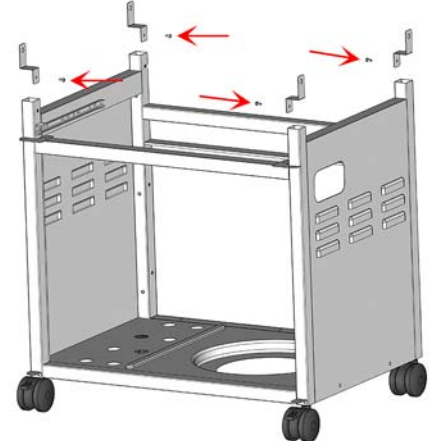

3. Set the grill assembly onto the top of the cabinet assembly as shown. Be sure the grill head lines up inside the mounting brackets on the top of the cabinet.

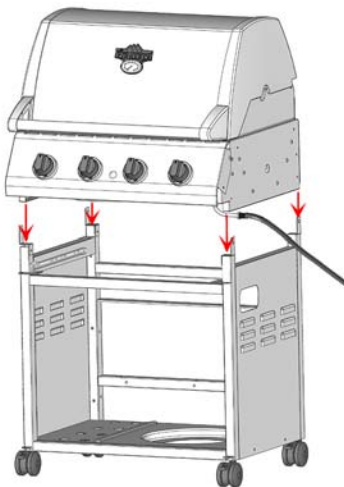

4. For each mounting bracket, insert a M5 screw. Tighten all four screws securely.

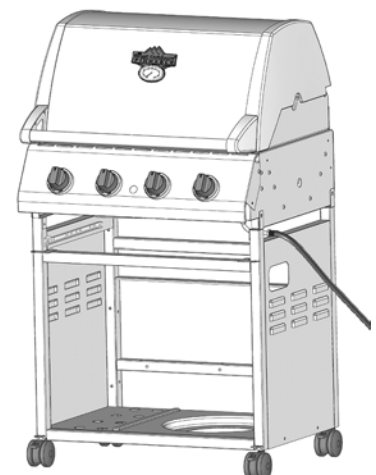
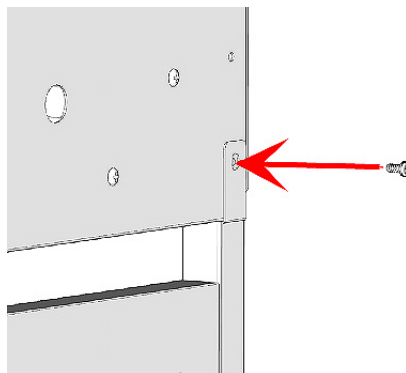



# Assembly Step 5—Assemble the Side Burner

## USE HARDWARE 'STEP 5'

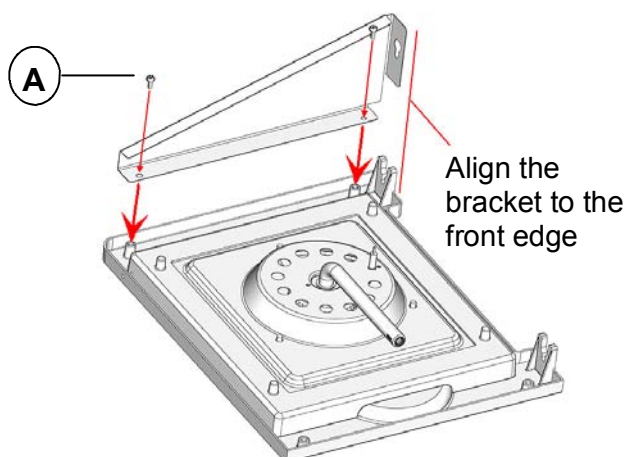
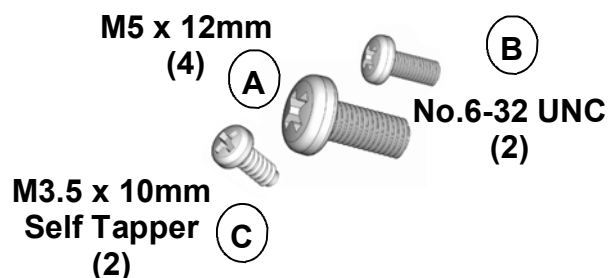

1. Attach the side table bracket as shown using M5 screws. Ensure that the front edges of the bracket and the burner table are aligned.
2. Secure the burner valve to the rear of the side table basket using No. 6-32 UNC screw through the bottom hole first. Fix the bezel into position and use the second No.6-32 UNC screw through the top hole of the bezel. Fix the two M3.5 self tapping screws through the bezel into the two remaining holes in the side table basket to the side burner valve.
3. Mount the 5 knobs onto the valve stems. Push the knobs securely onto the stems.

## LOCATE THESE PARTS

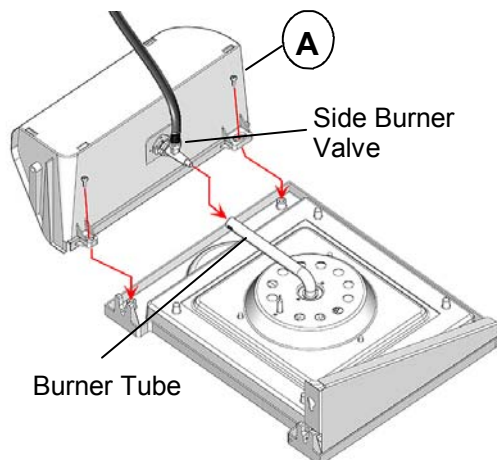
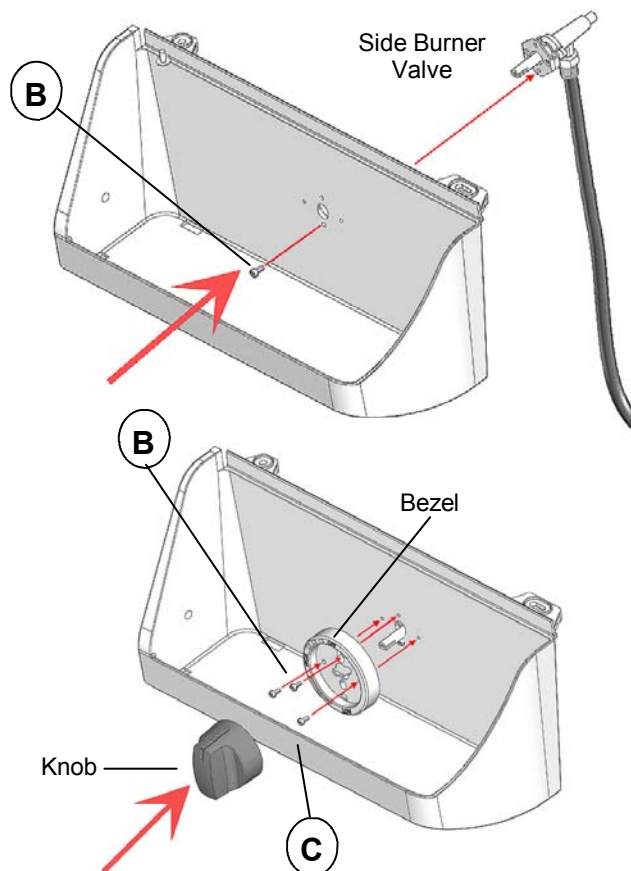
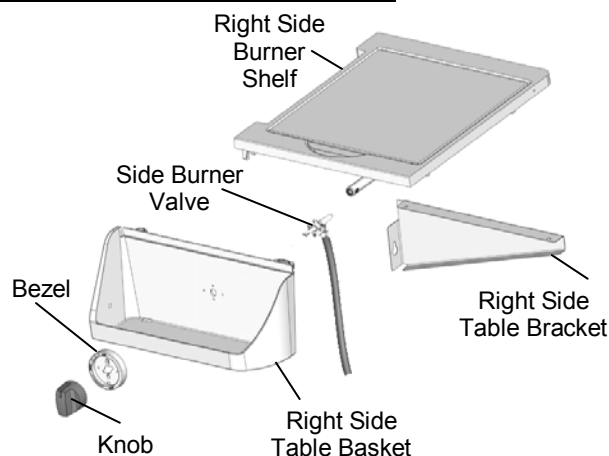

4. Attach the table basket with the burner valve to the burner shelf as shown. Secure the table using M5 screws, being careful to align the front edges of the table basket and the burner table.

**IMPORTANT - Ensure that the valve is correctly inserted into the burner tube.**



## Assembly Step 6—Attach the Right Side Table

### USE HARDWARE 'STEP 6'

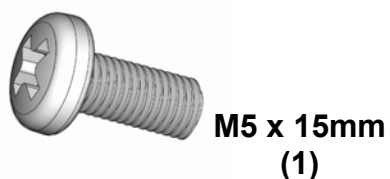

2. Line up the side table to the side of the grill head.

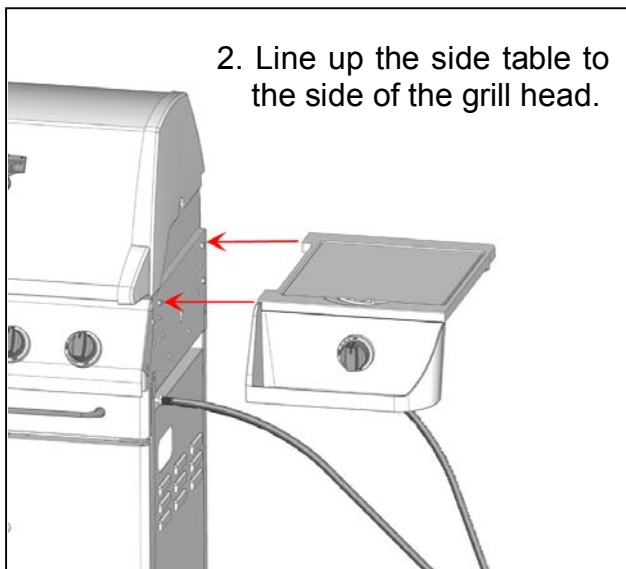

4. Insert a M5 screw through the side table basket and into the grill head. Do not tighten yet.

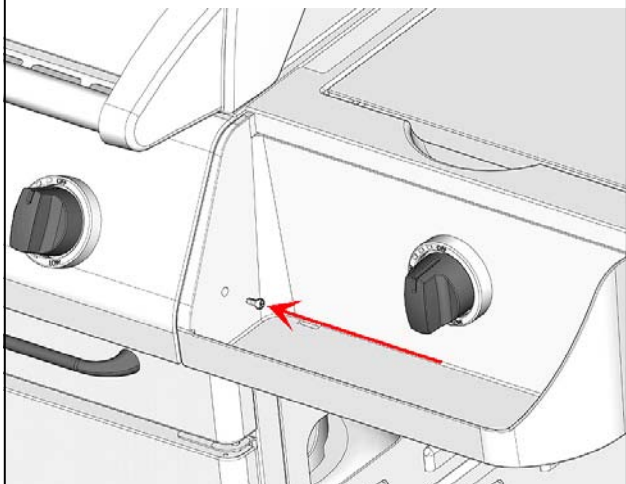

6. Tighten all screws securely.

1. Locate the three pre-installed screws on the side of the grill head. Loosen, but do not remove them.

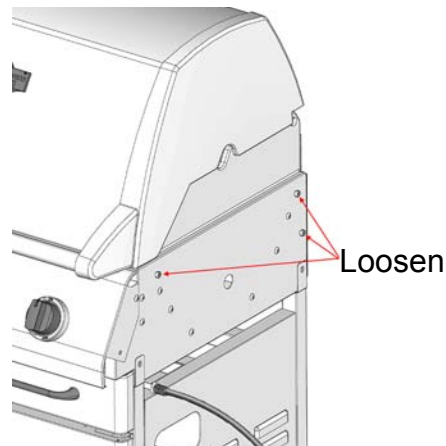

3. Capture the three loosened screws with the 3 mounting holes on the side table.

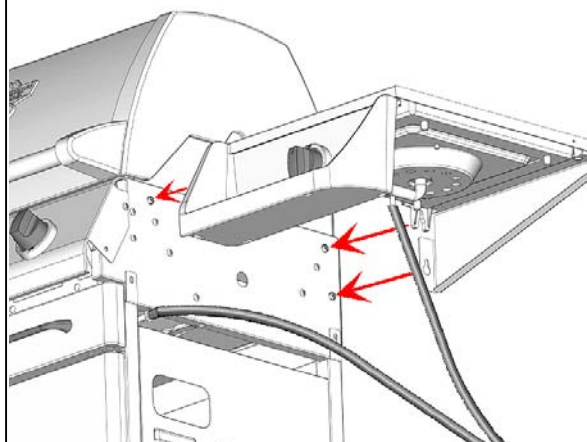

5. Locate the loose ignitor wire near the control panel and connect the loose end to the side burner ignitor electrode.

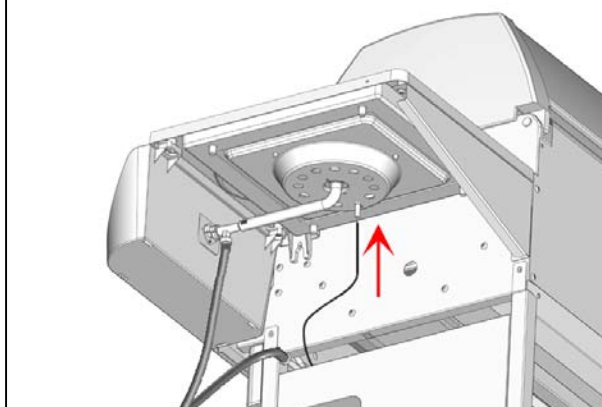

# Assembly Step 7 - Attach the Left Side Table

## USE HARDWARE 'STEP 7'

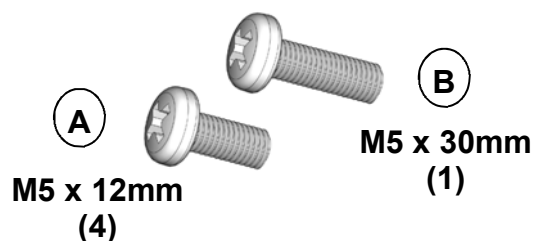

1. Attach the side table bracket as shown using M5 x 10 screws. Ensure that the front edges of the bracket and the side table are aligned

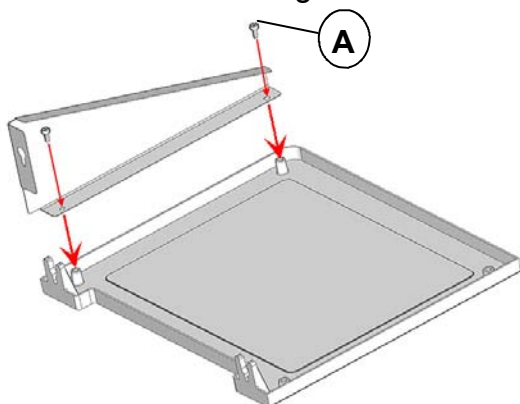

3. Attach the left side table as in Step 6. Loosen the 3 pre-installed screws on the side of the grill head but do not remove them. Capture the 3 loosened screws with the 3 mounting holes on the side table.

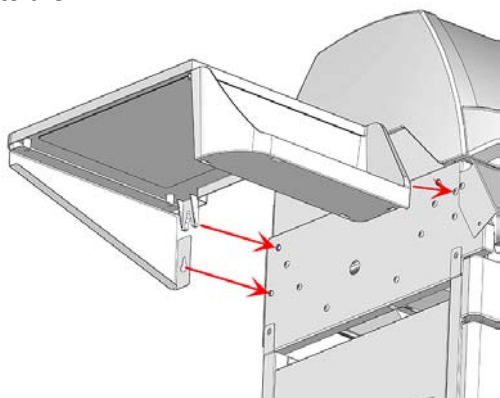

5. Tighten all screws securely.

## LOCATE THESE PARTS

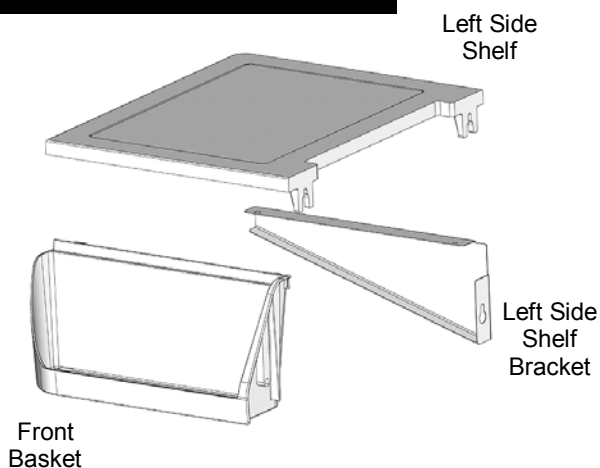

2. Attach the table basket to the side table as shown. Secure the table using M5 x 10 screws, being careful to align the front edges of the table basket and the side table.

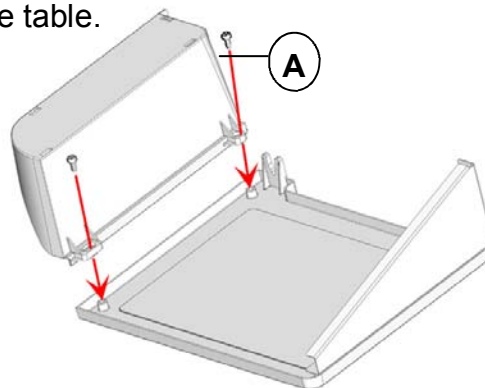

4. Insert a M5 x 15 screw through the side table basket and into the grill head.

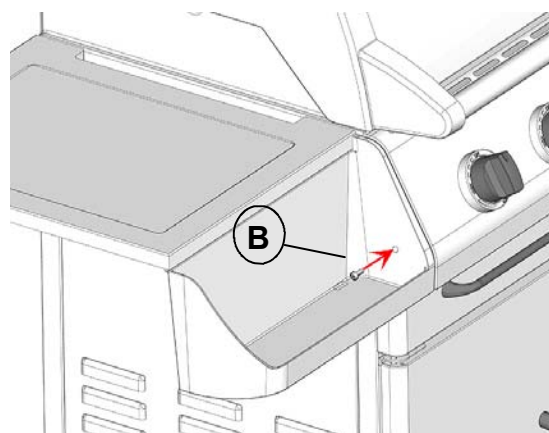

## Assembly Step 8—Install the Cooking Grids

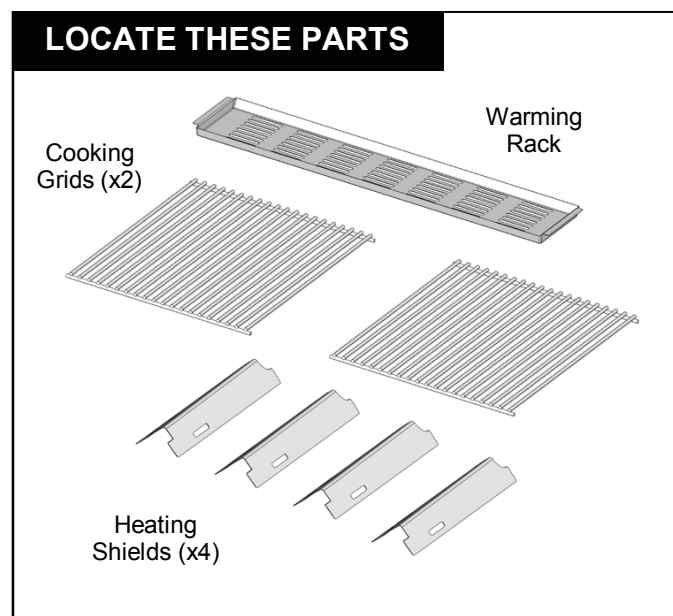

1. Insert the heat shields into the grill tub. Each heat shield must be placed above a burner, resting on the brackets in the front and rear of the grill tub. Note the orientation of the heat shields - the cutouts should be arranged to the front of the grill.

2. Place the cooking grids onto the top of the grill tub. They will rest just inside the top ledge of the tub.

3. Place the warming rack onto the side walls of the grill tub as shown.

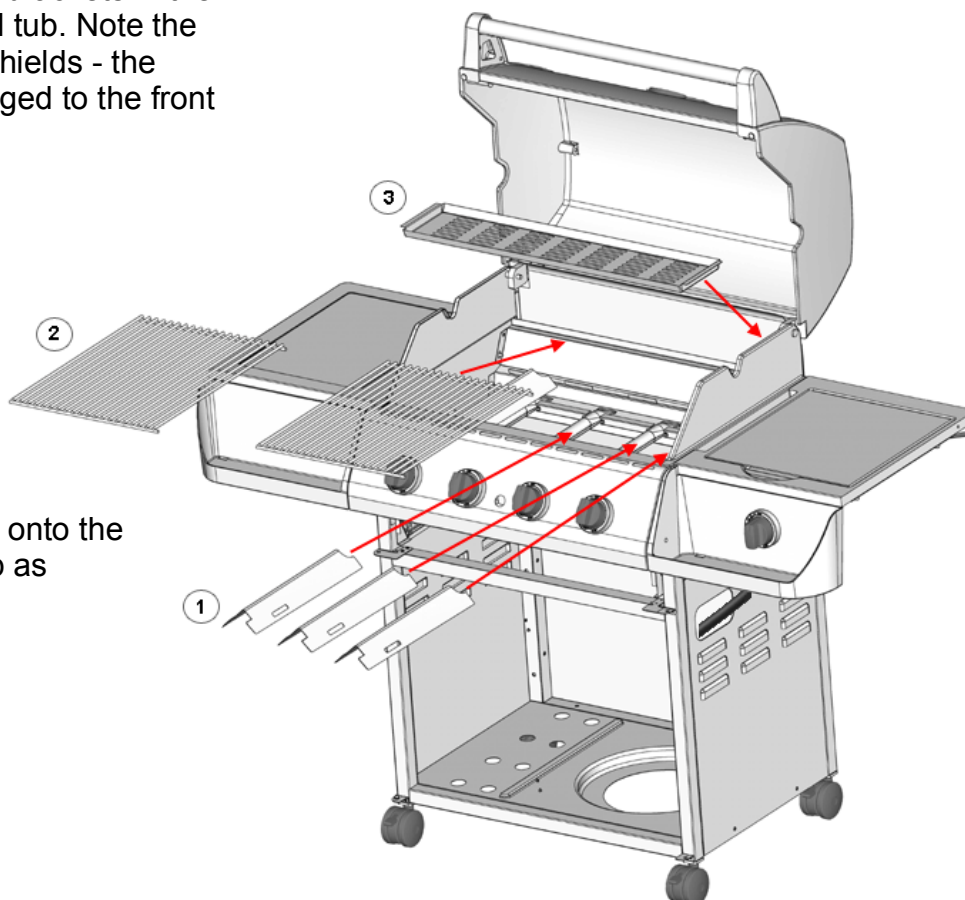

# Assembly Step 9—Install the Cabinet Doors

## USE HARDWARE 'STEP 9'

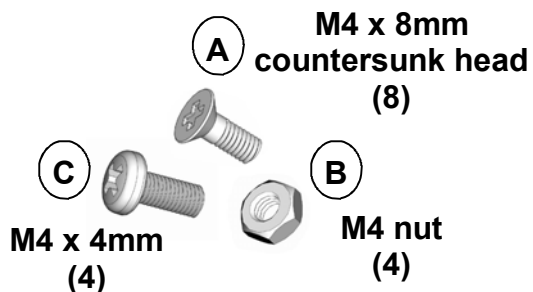

## LOCATE THESE PARTS

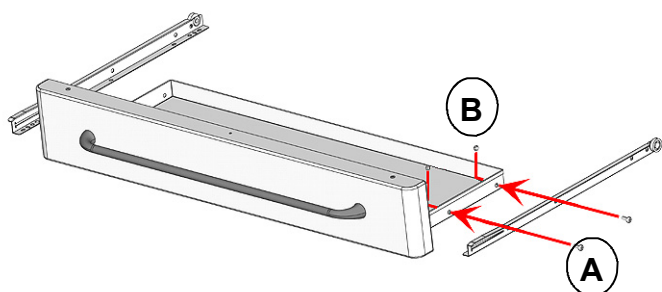
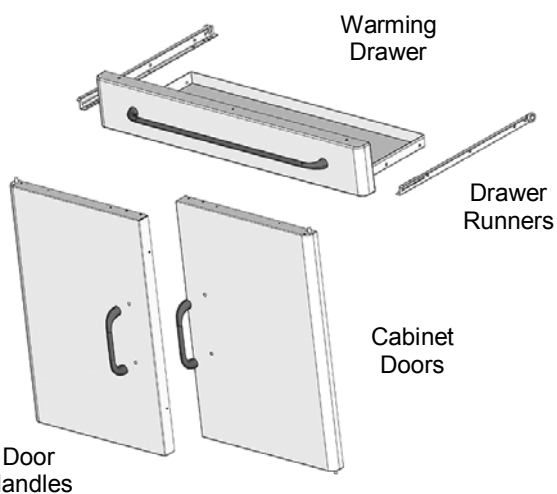

1. Fix the drawer runners to the warming drawer using M4 countersunk head screws and M4 nuts as shown.

2. Secure the door handles to the doors by fixing M4 screws through the circular cutouts at the rear of the door panels and into the handle as shown.

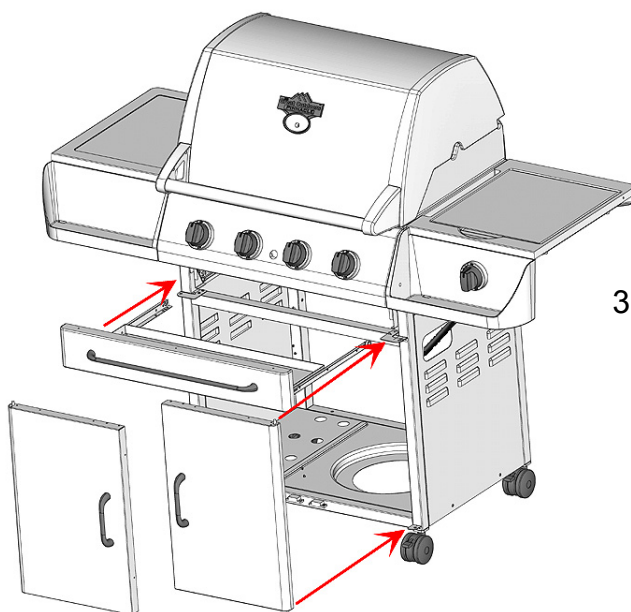
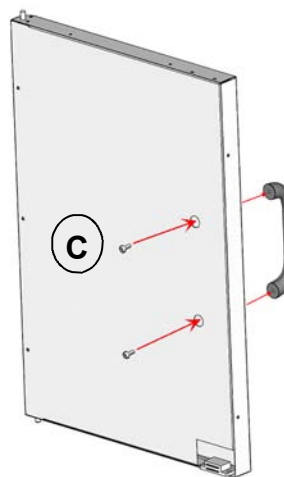

3. Mount the doors to cabinet as shown. The door pins are spring loaded. Locate the bottom corner of the doors onto the cabinet frame hinge brackets first. Then push in the pins on the top corner of the doors and locate into the top hinge brackets.



## Assembly Step 10—Install the Drip Pan

### LOCATE THESE PARTS

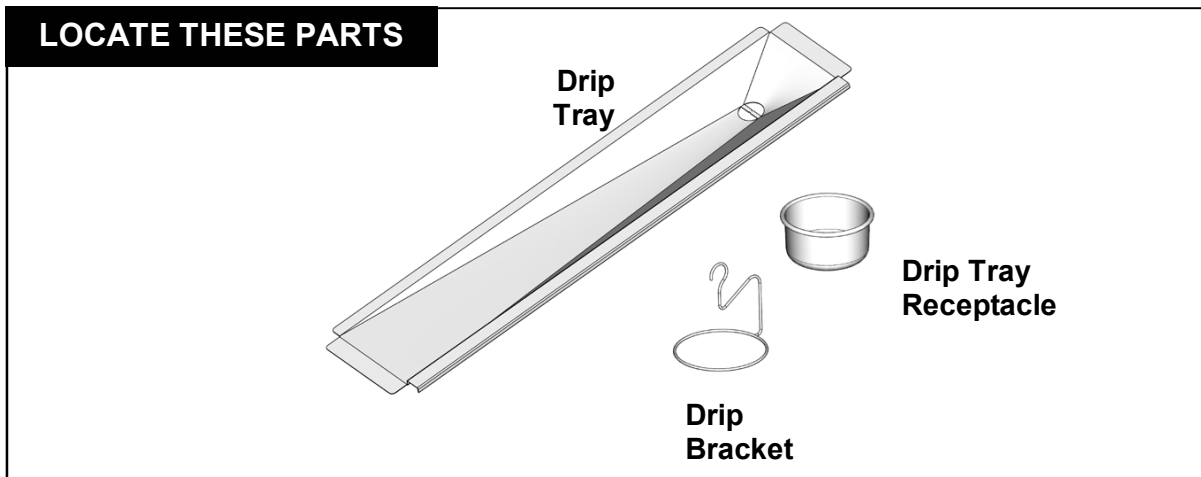

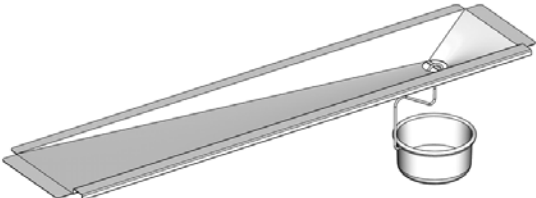
- 
1. Insert the drip tray receptacle into the bracket.
  2. Clip the bracket into the hole in the drip tray. **IMPORTANT:** The hole in the drip tray should be closest to the left side of the grill, as shown.
  3. From the rear side of the grill, insert the drip tray on the mounting tabs underneath the grill tub and slide in.

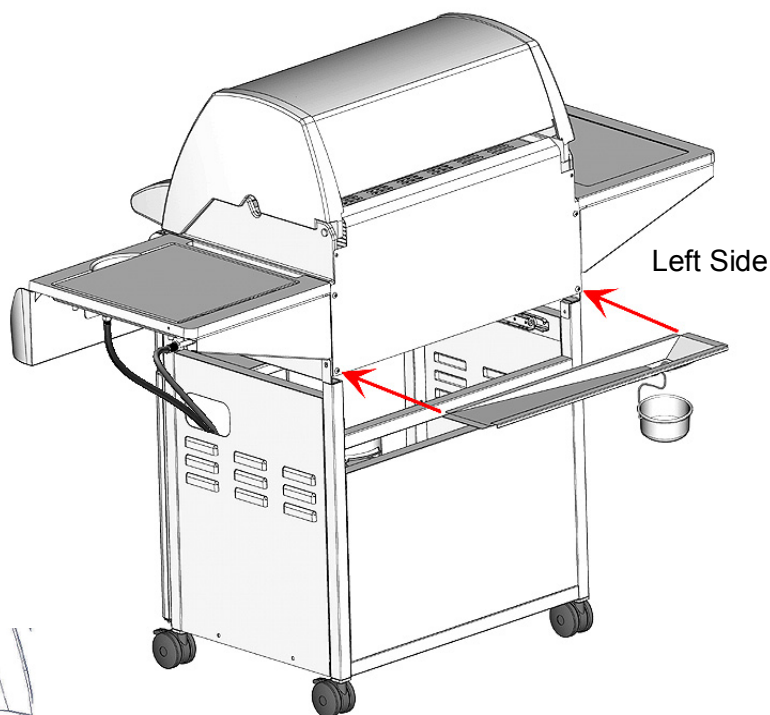

4. Install battery into ignitor on front console.

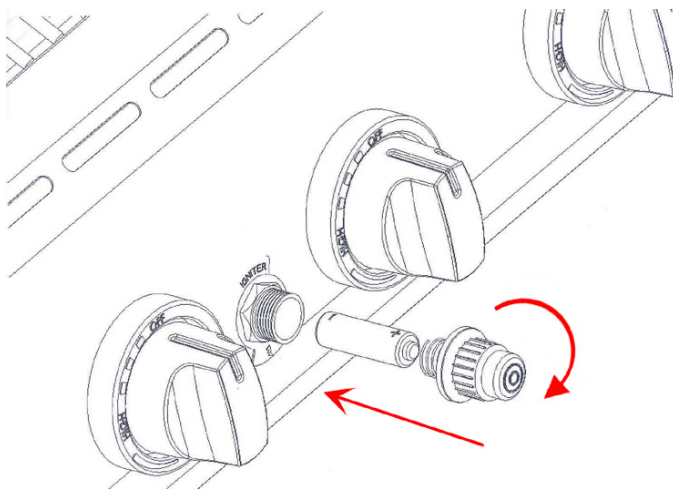

## Assembly Step 11 - Installing the L.P. Gas Cylinder

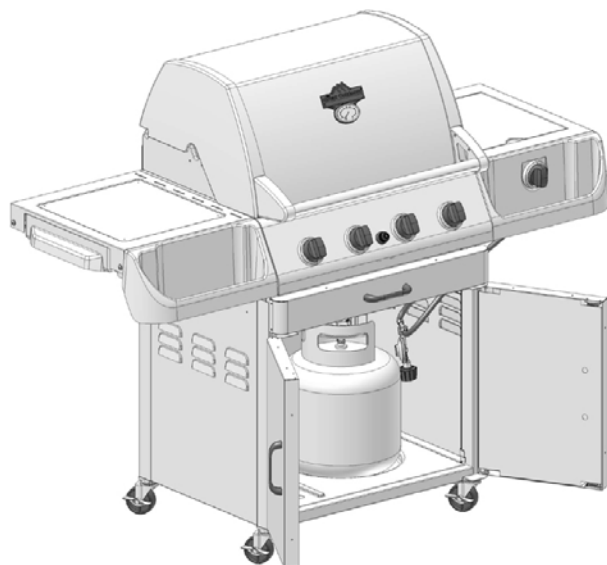
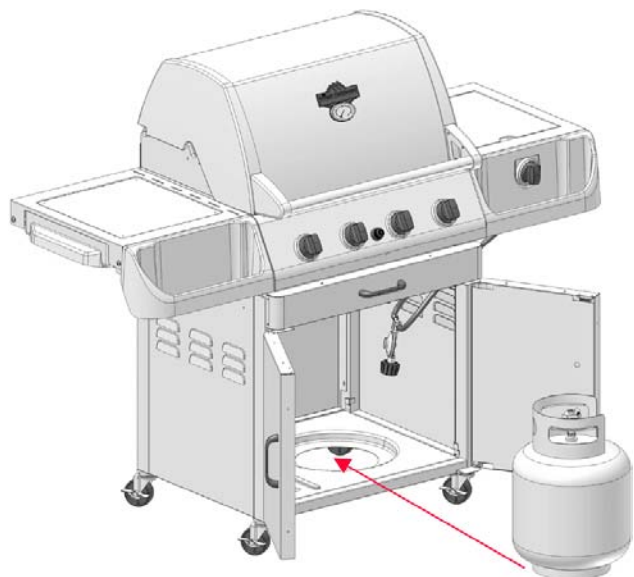

### L.P. Gas Cylinder Not Included

1. Set the L.P. Gas Cylinder upright into the bottom of the grill cabinet. The cylinder will sit securely into the seat in the bottom of the cabinet.
2. Place the Gas Cylinder Retaining Bracket over the gas cylinder carry handle and the other end of the bracket onto the rear square cross brace tube. Secure the bracket with the wing nut provided.
3. Connect the Hose / Regulator to the L.P. gas cylinder. Be sure to thread the coupler properly and securely.

*Refer to the following page for more instructions to properly connect the L.P. gas cylinder.*

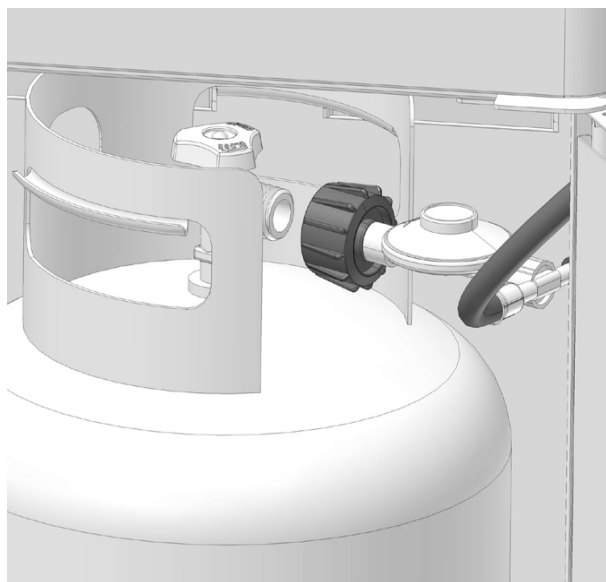
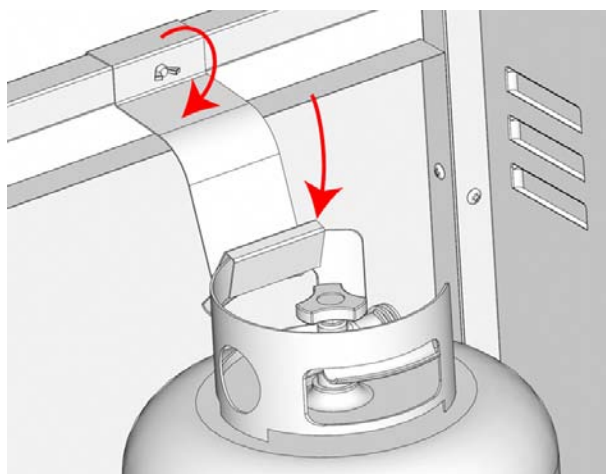

# Connecting the L.P. Gas Cylinder



Connecting the Regulator to Cylinder

1. The top knob on the supply cylinder must be closed. See that the top cylinder knob is turned clockwise to a full stop.
  2. Check that the grill burner knobs are turned off.
  3. Remove the protective caps from the cylinder valve and coupling nut, if present.
  4. Hold the regulator in one hand and insert the nipple into the valve outlet. Be sure the nipple is centered in the valve outlet. The coupling nut connects to the large outside threads on the valve outlet. Use care not to cross thread the connection.
  5. Hand tighten the coupling nut clockwise until it comes to a full stop. Tighten by hand only. Do not use tools.
  6. **CAUTION:** In the connection process, the grill side of the connection will seal on the back check in the valve, resulting in a slight resistance. The connection requires about one-half to three-quarters additional turn to complete the connection.
- NOTE: If you cannot complete the final connection, disconnect the regulator and repeat steps 4 through 6. If you are still unable to complete the connection do not use this valve and regulator.
7. Make sure the hose has no kinks or sharp bends and clears any area that will become hot during use. Never put strain on the hose where it joins a fitting. The rubber fuel supply hose must not touch the bottom grill casting during use.
  8. Before lighting grill, check all connections for leaks using mild soapy-water solution.
  9. Make sure the Drip Pan is in place underneath the grill tub. During use the pan will catch hot grease drippings that could damage the fuel supply system.





[www.cfmcorp.com](http://www.cfmcorp.com)

Service Note: If you are experiencing difficulties or are dissatisfied with your purchase, please contact CFM at the telephone number listed above prior to returning your grill to the store.